

Preparation Lubrication [Ordinary use] Additional Functions [Advanced use]

Parts Identification

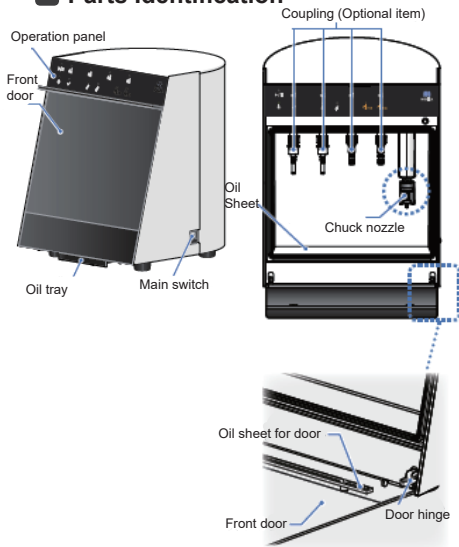

Chuck cleaning

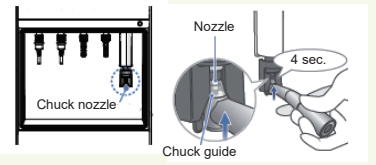

1. Line up the front end of the head with the nozzle guide and set the chuck in place.
2. Lift the handpiece up slightly.
3. Hold it in place for about 4 seconds until Lubrina 2 beeps.

Lubrication [Mode 1 / Mode 2]

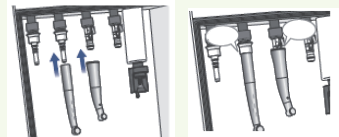

1. Connect a handpiece to its coupling.
2. Press the selector switch matching the connected handpieces.
3. Press the START/STOP switch.

Recommended modes

Type of Handpiece	Recommended mode	
	Mode 1 (Operation time 20sec. per one)	Mode 2 (Operation time 40sec. per one)
Air Turbine Handpiece	●	
Straight attachment		●
Reduction contra-angle attachment		●
One to One contra-angle attachment		●
Speed increasing contra-angle attachment		●
Air Scaler	●	
Air Motor		●
	Air Torx	●
	Tri Auto ZX	●
Root Canal Enlargement system		●
	Tri Auto ZX2	●
	Dentaport	●
	Tri Auto mini	●

Default Setting: Selector 1 / 2 → Mode 1
Selector 3 / 4 → Mode 2

① High speed contra angle must be maintained using mode 2.

Parts Identification

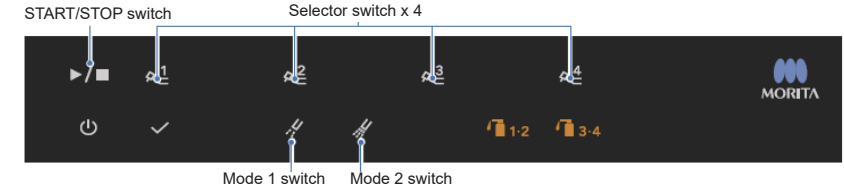

- START/STOP switch: Start or stop lubrication
- Mode 1 switch: Select this for items listed under Mode 1 in the Recommended Mode table.
- Mode 2 switch: Select this for items listed under Mode 2 in the Recommended Mode table.
- Selector switch x 4: Selector (1 - 4)

Lubrication [Flushing mode]

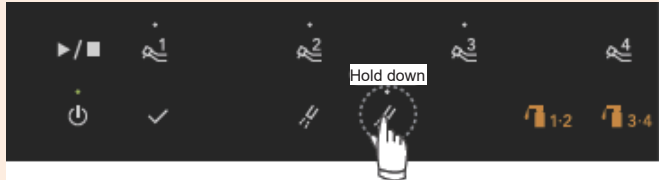

- Use when the head is particularly dirty to help purge it.
1. Press the selector switch for the connected handpiece.
 2. Hold down the selector switch for 2 seconds.
 - ※ Selector switches 1 - 3 are selected in the illustration above.

Air blow mode

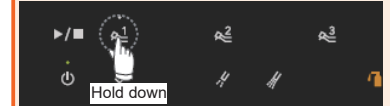

- To remove excess oil more thoroughly
1. Hold down the selector switch for the connected handpiece.
 2. Air blow starts after holding down the selector for 2 seconds. Air blow mode takes about 30 seconds. (Maximum)
 3. Press the START/STOP switch if you need to interrupt this mode during the cycle.

Preparation

■ Connecting the Spray can

1. Remove the cap and spout from the spray can.

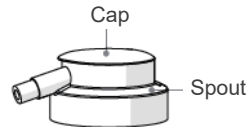

2. Open the rear cover and insert the spray can nozzle.

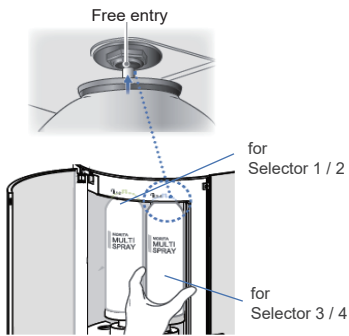

3. Raise the spray lever to a vertical position, holding the can in place.

Pull and push the cans to make sure they are secure and do not wobble.

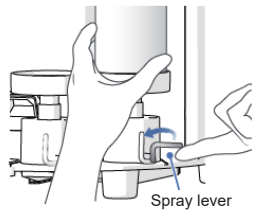

- ⓘ Make sure the lever is securely fixed using your finger.

■ Connecting the couplings

Couplings for Lubrina cannot be used with Lubrina 2.



1. Insert the coupling with the large pipe on the right.

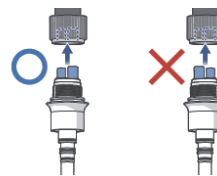

2. Fit the coupling onto the 4H connector and tighten its fixture.

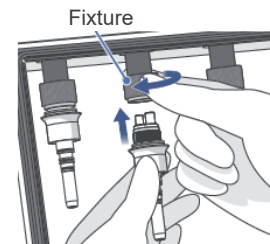

- ⓘ Do not tighten the fixture with pliers or other tools. This will damage the coupling.

■ Oil sheet

Set the oil sheet while paying attention to the direction.

※There is no fixed direction for up or down.

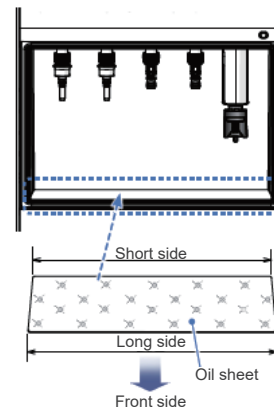

■ Oil tray and Oil pad

Pull the oil tray out, remove the oil pad from the tray and replace it with new one.

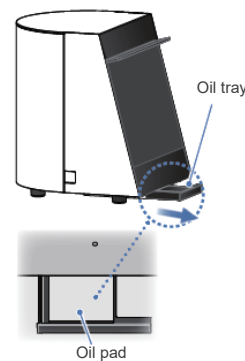

- ⚠ Ensure the oil tray is securely fixed.

■ Oil sheet / Sheet stopper for door

1. Align the sheet stopper for door to the holes in the oil sheet for door.

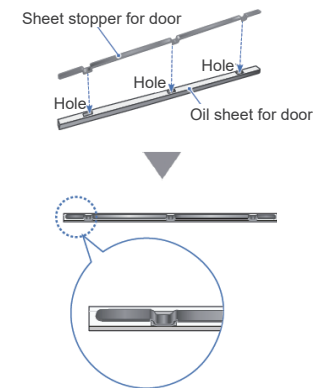

2. Fix the sheet stopper to the magnet on the front door.

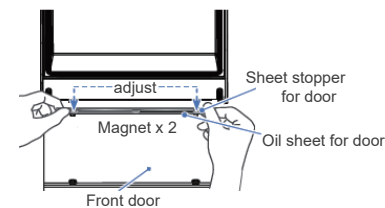
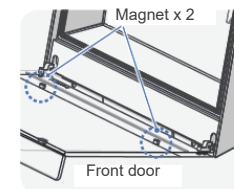

■ How to change maintenance mode

1. Turn the main switch on and open the front door to avoid inadvertent operation.
2. Hold down the selector you want to change and the hold the START/STOP switch for 2 seconds. The selector and mode lamp will start blinking. An audible beep will sound.



3. Press the mode switch you want to use for this selector.

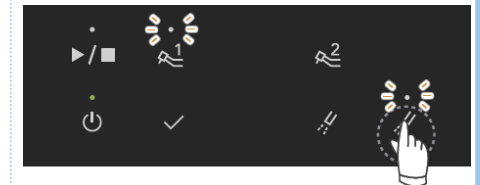

4. Hold down the START/STOP switch for seconds. The lamp will stop blinking indicating that the change is saved.

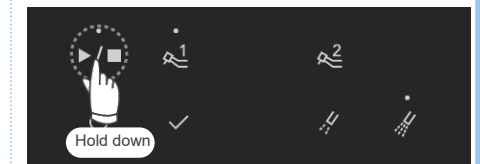

Selector 1 mode has been changed to 2 in the illustration above.

5. Turn the main switch off.